

Old Oak and Park Royal Public Realm and Connectivity Strategy

Client: Old Oak & Park Royal Development Corporation (OPDC) and TfL
Collaborators: Alan Baxter, Martin Wedderburn

Old Oak and Park Royal is set to undergo radical change with the arrival of HS2, Crossrail, and two new overground stations - Old Oak Common Lane Station and Hythe Road Station. The delivery of 55,000 new jobs, and 24,000 new homes into the Old Oak area, is catalysed by the arrival of the new stations and the release of rail land.

5th Studio have produced a Public Realm Strategy and Design Guide for Old Oak and Park Royal - based on analysis of the Public Realm, Cycling and Pedestrian networks described in the Old Oak Development Corporation's Draft Local plan, alongside an in depth review of the topographical and infrastructural constraints affecting the site.

The strategy identifies clear design principles for the future public realm movement network and spaces. As a supporting document and evidence base to the OPDC's forthcoming Local Plan, the strategy will become a Supplementary Planning Document, and will provide a framework for delivering an exemplar, sustainable, and accessible urban environment.

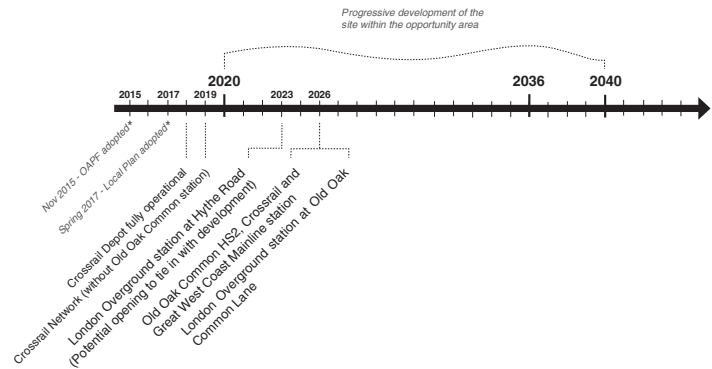

Above Timeline for the proposed development of Old Oak with dates noted for the new stations.

Below Overview drawing of Old Oak High Street highlighting the proposed characterful public realm spaces at Willesden Junction, Hythe Road and Old Oak Common Station Interchange.

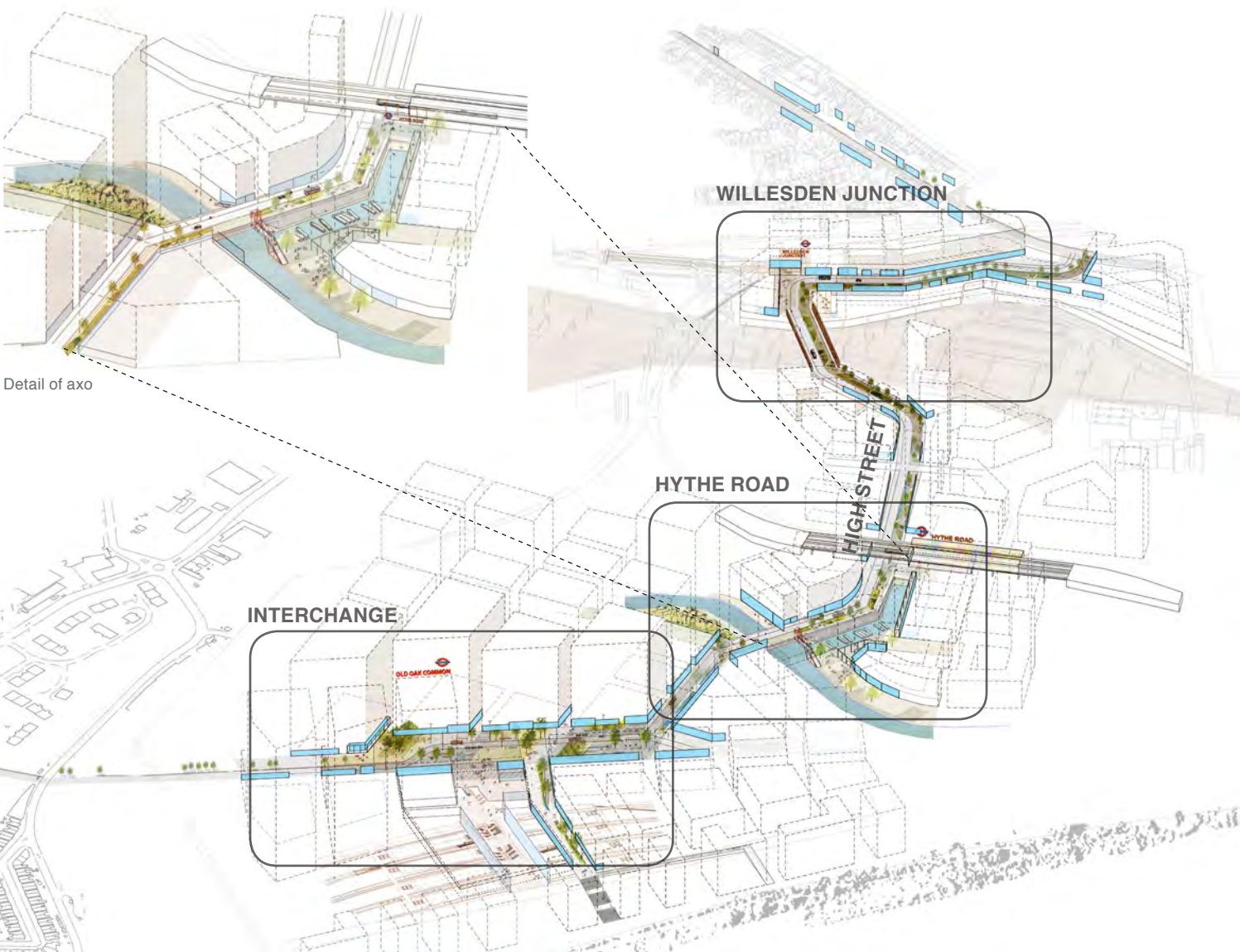

Detail of axo

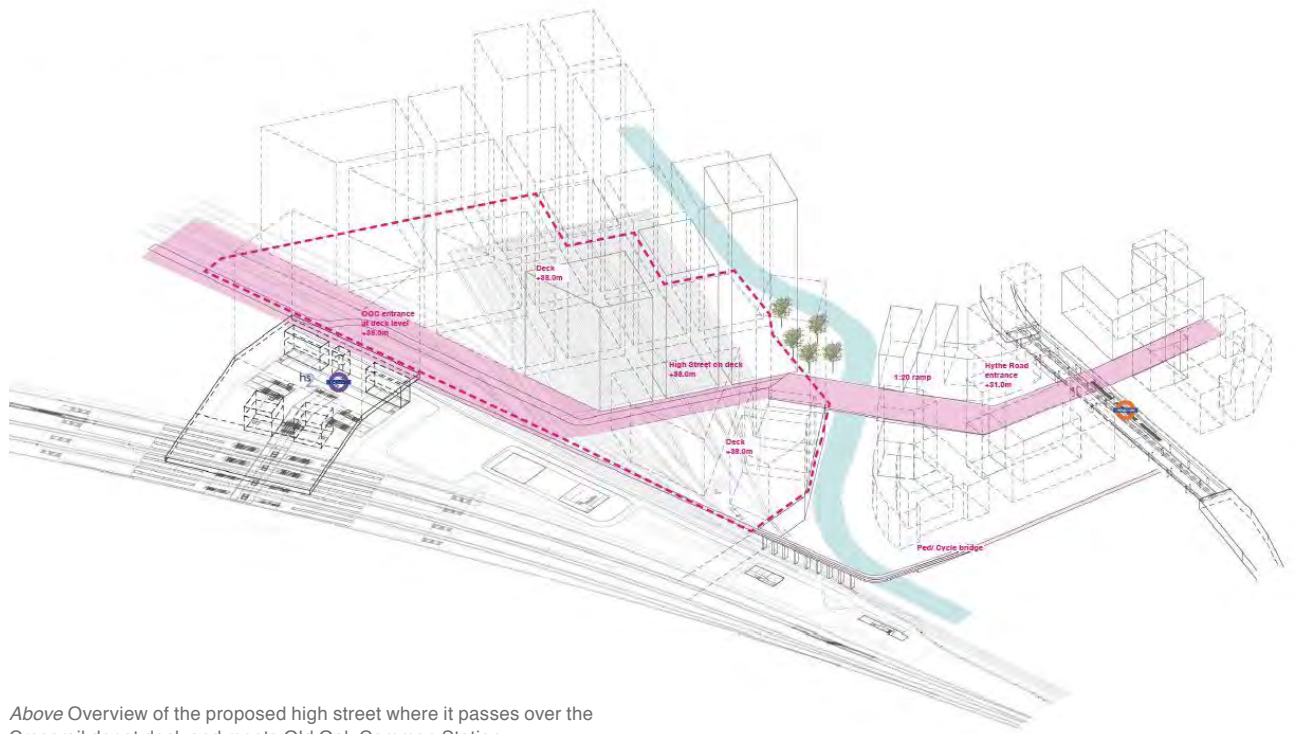

Above Overview of the proposed high street where it passes over the Crossrail depot deck and meets Old Oak Common Station.



Above Views along the Grand Union canal

Below Section at Willesden Junction showing a proposed high level deck in order to get over the North London Line.

